

Entry / ECO

Standard / STD

Professional / PRO

ODM & OEM

Intelligent / INT



LED Ceiling Light
AL127 Series





Introduction

AL127 is a new super slim design ceiling light, adopting high lumen SMD LED and lighter weight fire-rated material to ensure better heat resistance and corrosion resistance. The base and shade are detachable which make easier maintenance and installation. Besides, for wire connection, it could through the edge side or back side, which meets wider installation demand.

Features

- Rotate design for quick install, available for both edge wire enter and back side wire enter.
- High lumen efficiency, 100lm/W @4000K.
- IP54 for the whole lamp , IK08.
- Interchangeable CCT by slide switch: 3000K/4000K/5700K.
- Interchangeable power by slide switch.
- Flicker free driver, support triac dim and DALI dim.
- Multiple functions : Microwave sensor, Emergency.
- Decorative lighting effect from side view contributes a strong sense of substantiality

Application Areas

It is designed for general lighting applications. It is also widely used for public areas, such as stairway, lobby, reception, corridors etc.

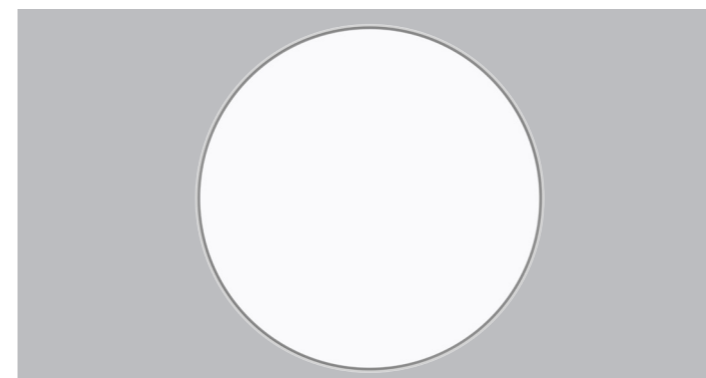

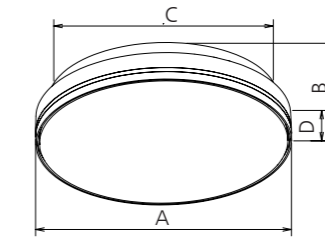

Measurement

Code	Dimension(mm)				Size(mm)	Product Weight (Kg)		Package weight (Kg)		Carton Size(cm)	Qty/CTN	20GP (pcs)	40HQ (pcs)
	A	B	C	D		N.W/PC	G.W/PC	N.W/CTN	G.W/CTN				
AL127-10-12W	250	58	220	36	Ø250*58	0.81	0.94	9.72	13	52.5*37*53	20	5280	10720
AL127-12-18W	300	58	270	36	Ø300*58	0.81	0.94	9.72	13	73*33*33	10	3570	7560
AL127-12-25W	300	58	270	36	Ø300*58	1.23	1.42	12.3	15.5	73*33*33	10	3570	7560
AL127-16-25W	400	58	383	36	Ø400*58	1.23	1.42	12.3	15.5	70*43*43	10	2100	5280
AL127-16-30W	400	58	383	36	Ø400*58	1.23	1.42	12.3	15.5	70*43*43	10	2100	5280

Technical Data Sheet

Code No.	AL127-10-12W	BA2014-AL127-18W	AL127-12-25W	AL127-16-25W	AL127-16-30W		
Dimension(mm)	Ø250*58	Ø300*58	Ø300*58	Ø400*58	Ø400*58		
Cutout (mm)	-						
Watt(W)	12W	18W	25W	25W	30W		
Rated Input Voltage(V)	AC220-240V						
Input Voltage(V)	AC200-240V						
LED Module Input	-						
Light Source	SMD						
SDCM	<6 (@3000K 4000K 5000K)						
CCT(K)	1-CCT: 3000K/4000K/5000K/5700K 3-CCT: 3000K + 4000K + 5700K						
CCT Selection DIP Switch	YES						
Luminous Flux (lm) ±5%	Non-DIM	1-CCT	1020-1300	1500-1900	2100-2700	2250-2800	2500-3200
			1000-1260	1450-1850	2050-2650	2240-2780	2450-3100
	DIM	3-CCT	1020-1300	1500-1900	2100-2700	2260-2900	2500-3200
			1000-1260	1450-1890	2050-2650	2250-2800	2450-3100
CRI	≥80						
Beam Angle (°)	120°						
UGR	-						
LED Driver	Built-in						
Dimming Option	Triac/DALI						
Sensor	Microwave sensor & daylight sensor						
Emergency Kits	Yes						
Electrical Class	Class II						
Ingress Protection (IP Rating)	IP54						
Impact Resistance (IK Rating)	IK08						
Product Finishing(Base)	White RAL 9016						
Materials of Optics	PC						
Materials of Housing	PC						
Lifetime (hr)	50,000h						
Glow wire test (°C)	750°C						
Operating Temp. (°C)	-20°C ~40°C						
Storage Temp. (°C)	-20°C ~65°C						
Installation	Surface mount						

Technical Data Sheet

Code No.	AL127-12-25W-A3	AL127-16-30W-A3		
Dimension(mm)	Ø300*58	Ø400*58		
Cutout (mm)	-			
Watt(W)	15W/20W/25W	18W/25W/30W		
Rated Input Voltage(V)	AC220-240V			
Input Voltage(V)	AC200-240V			
LED Module Input	-			
Light Source	SMD			
SDCM	<6 (@3000K 4000K 5000K)			
CCT(K)	1-CCT: 3000K/4000K/5000K/5700K 3-CCT: 3000K + 4000K + 5700K			
CCT Selection DIP Switch	YES			
Luminous Flux (lm) ±5%	Non-DIM	1-CCT	15W 1300-1580	18W 1500-1900
			20W 1700-2100	25W 2250-2800
	DIM	3-CCT	25W 2200-2630	30W 2500-3200
			-	-
Luminous Flux (lm) ±5%	Non-DIM	3-CCT	15W 1300-1600	18W 1500-1920
			20W 1700-2120	25W 2250-2820
	DIM	3-CCT	25W 2200-2650	30W 2500-3220
			-	-
CRI	≥80			
Beam Angle (°)	120°			
UGR	-			
LED Driver	Built-in			
Dimming Option	NO			
Sensor	NO			
Emergency Kits	NO			
Electrical Class	Class II			
Ingress Protection (IP Rating)	IP54			
Impact Resistance (IK Rating)	IK08			
Product Finishing(Base)	White RAL 9016			
Materials of Optics	PC			
Materials of Housing	PC			
Lifetime (hr)	50,000h			
Glow wire test (°C)	750°C			
Operating Temp. (°C)	-20°C ~40°C			
Storage Temp. (°C)	-20°C ~65°C			
Installation	Surface mount			

Driver Datasheet(Non-dimmable)

Total load wattage		12W		18W		25W		30W	
Output	Output Voltage range	DC60-75V							
	Rated output current	160mA	240mA	320mA	395mA				
	Line Regulation	±5%							
	Setup, Rise Time	<0.5S							
	Flickering Index	3%,IEEE1789 NO RISK							
Input	Input Voltage	AC200-240V							
	Rated Input Voltage(V)	AC230V							
	Frequency	50/60Hz							
	Input Current	≤0.07A	≤0.1A	≤0.14A	≤0.17A				
	Rated Input Current	≤0.06A	≤0.09A	≤0.13A	≤0.15A				
	Power Factor	0.9							
	THD	-	-	<20% @230V					
	Efficiency	≥86%							
	No load wattage	<0.5W							
	Protection	Short circuit protection	Pass						
Over voltage protection		Pass							
Over temperature protection		Pass							
Safety &EMC	Withstand voltage	I/P-O/P:3.75KVac, <5mA 60S							
	Isolation Resistance	I/P-O/P: 500VDC, ≥100M Ω							
	Surge	IEC/EN61000-4-5(P<25W; L-N:500V)				IEC/EN61000-4-5 (P≥25w L-N:1KV)			
	EMC Emission	EN55015, EN61000-3-2							
	EMC Immunity	EN61000-4-2,3,4,5,6,8,11; EN61547							

Driver Datasheet(Non-dimmable for sensor)

Total load wattage		12W		18W		25W		30W	
Output	Output Voltage range	DC60-75V							
	Rated output current	145mA	220mA	320mA	370mA				
	Line Regulation	±5%							
	Setup, Rise Time	<0.5S							
	Flickering Index	3%,IEEE1789 NO RISK							
Input	Input Voltage	AC85-265V							
	Rated Input Voltage(V)	AC100-240V							
	Frequency	50/60Hz							
	Input Current	≤0.16A	≤0.24A	≤0.33A	≤0.4A				
	Rated Input Current	≤0.14A	≤0.20A	≤0.28A	≤0.34A				
	Power Factor	0.9							
	THD	<20% @230V							
	Efficiency	≥84%				≥86%			
	No load wattage	<1W							
	Protection	Short circuit protection	Pass						
Over voltage protection		Pass							
Over temperature protection		Pass							
Safety &EMC	Withstand voltage	-							
	Isolation Resistance	-							
	Surge	IEC/EN61000-4-5(P<25W; L-N:500V)							
	EMC Emission	EN55015, EN61000-3-2							
	EMC Immunity	EN61000-4-2,3,4,5,6,8,11; EN61547							

Driver Datasheet(Adjustable power)

Total load wattage		15W/20W/25W			18W/25W/30W		
Output	Output Voltage range	DC60-75V					
	Rated output current	200mA	260mA	320mA	240mA	330mA	390mA
	Line Regulation	±5%					
	Setup, Rise Time	<0.5S					
	Flickering Index	3%,IEEE1789 NO RISK					
Input	Input Voltage	AC200-240V					
	Rated Input Voltage(V)	AC230V					
	Frequency	50/60Hz					
	Input Current	≤0.09A	≤0.12A	≤0.14A	≤0.1A	≤0.14A	≤0.17A
	Rated Input Current	≤0.08A	≤0.1A	≤0.13A	≤0.09A	≤0.13A	≤0.15A
	Power Factor	0.9					
	THD	-	<20% @230V		-	<20% @230V	
	Efficiency	≥86%					
	No load wattage	<0.5W					
	Protection	Short circuit protection	Pass				
Over voltage protection		Pass					
Over temperature protection		Pass					
Safety &EMC	Withstand voltage	I/P-O/P:3.75KVac, <5mA 60S					
	Isolation Resistance	I/P-O/P: 500VDC, ≥100M Ω					
	Surge	IEC/EN61000-4-5 (P≥25w L-N:1KV)					
	EMC Emission	EN55015, EN61000-3-2					
	EMC Immunity	EN61000-4-2,3,4,5,6,8,11; EN61547					

Driver Datasheet(Triac Dimmable)

Total load wattage		12W		18W		25W		30W	
Output	Output Voltage range	DC60-75V							
	Rated output current	140mA	230mA	320mA	390mA				
	Line Regulation	±5%							
	Setup, Rise Time	<1S							
	Flickering Index	<5% (LOW RISK)							
Input	Input Voltage	AC200-240V							
	Rated Input Voltage(V)	AC230V							
	Frequency	50Hz							
	Input Current	≤0.07A	≤0.1A	≤0.14A	≤0.17A				
	Rated Input Current	≤0.06A	0.09A	0.13A	0.15A				
	Power Factor	0.9							
	THD	<20% @230V							
	Efficiency	≥81%	≥83%	≥84%	≥84%				
	No load wattage	<1W							
	Protection	Short circuit protection	Pass						
Over voltage protection		Pass							
Over temperature protection		Pass							
Safety &EMC	Withstand voltage	-							
	Isolation Resistance	-							
	Surge	IEC/EN61000-4-5(P>25W; L-N:500V)							
	EMC Emission	EN55015, EN61000-3-2							
	EMC Immunity	EN61000-4-2,3,4,5,6,8,11; EN61547							

Driver Datasheet(Dali Dimmable)

Total load wattage		12W	18W	25W	30W
Output	Output Voltage range	DC30-40V			
	Rated output current	300mA	450mA	600mA	750mA
	Line Regulation	±5%			
	Setup, Rise Time	<1S			
	Flickering Index	<1% (NO RISK)			
Input	Input Voltage	AC180-264V			
	Rated Input Voltage(V)	AC200-240V			
	Frequency	50Hz			
	Input Current	≤0.08A	≤0.12A	≤0.16A	≤0.19A
	Rated Input Current	≤0.07A	0.1A	0.14A	0.17A
	Power Factor	0.9			
	THD	<20% @230V			
	Efficiency	≥82%	≥83%	≥85%	≥86%
	No load wattage	<0.5W			
	Protection	Short circuit protection	Pass		
Over voltage protection		Pass			
Over temperature protection		Pass			
Safety & EMC	Withstand voltage	I/P-O/P:3.75KVac, <5mA 60S			
	Isolation Resistance	I/P-O/P: 500VDC, ≥100M Ω			
	Surge	IEC/EN61000-4-5(P<25W; L-N:500V)		IEC/EN61000-4-5 (P≥25W L-N:1KV)	
	EMC Emission	EN55015, EN61000-3-2			
	EMC Immunity	EN61000-4-2,3,4,5,6,8,11; EN61547			

Datasheet (Sensor S7)

Sensor datasheet	
Operating Voltage	DC7-12V
Microwave frequency	5.8GHz±75MHz, ISM wave band
Detection angle	140°
Detection Area	4-6M
Hold time	5S/60S/3min/10min
Daylight sensor	30lux/disable
Stand-by DIM Level	0% / 20%
Stand-by Period	15min /∞
Dimming Range	-
Microwave ON/OFF function	-
Installation Height	Recommended Installation Height: Wall mounted height 1.8m. Ceiling mounted height 3m.
Minimum mounting distance	recommended install height should be more than 3m
Operating temperature(°C)	-20°C ~60°C

Driver Datasheet (Emergency)

Power	3W
Rated Input Voltage(V)	AC230V
Frequency	50/60Hz
Input Voltage(V)	200-240V
Total load Wattage	3W±0.5W
Rated input current	≤0.03A
Battery	6.4V 1500mAh(LiFePO4)
Lifetime (hr)	Over 2000 cycles
Battery duration	≥3hrs
Charge Period	24H
Emergency switching time	≤ 1S

Wiring Diagram:

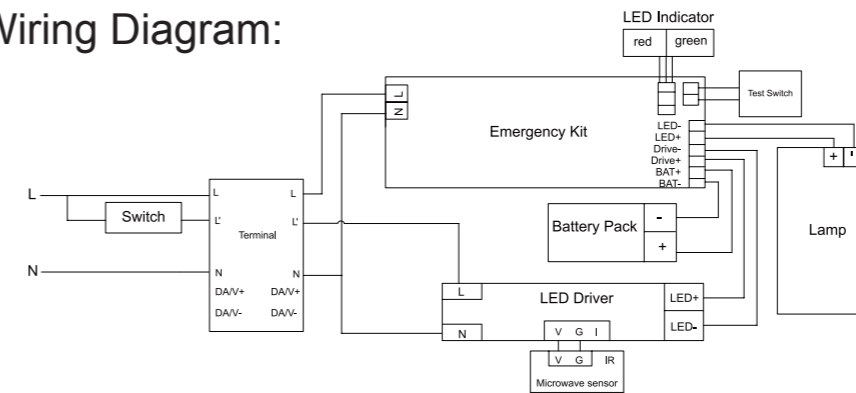

Instructions for automatic test option

1. Once the unit is powered up it will automatically initiate a self test and diagnostics as follows:

- Every 4seconds: Check for battery disconnection, charger board fault, lamp failure and transformer failure.
 - Every month: Perform a 3minutes duration test.
 - Every year: Perform a 1 Hour or 3 Hours duration test.
- All test functions are factory preset and do not need field adjustment.

2. Dual Colour Indicator LED Status Meanings

- Green Solid On Ready/Normal Operation
- Red Requires Service

•	One flash, 4 seconds pause	Battery not connected
••	Two flashes, 4 seconds pause	Low battery voltage
•••	Three flashes, 4 seconds pause	Charger board fault
••••	Four flashes, 4 seconds pause	Transformer fault
•••••	Five flashes, 4 seconds pause	LED lamp fault

NOTE: After repairing a service fault, press and hold the test button for 2 seconds to reset the flashing indicator light to green.

3. Manual Test

Press test button once	30 seconds duration test
Press test button twice within 2 seconds	3 minutes duration test
Press test button 3 times within 2 seconds	30 minutes duration test
Press test button 4 times within 2 seconds	1 or 3 hours duration test

Daylight & Microwave Sensor:

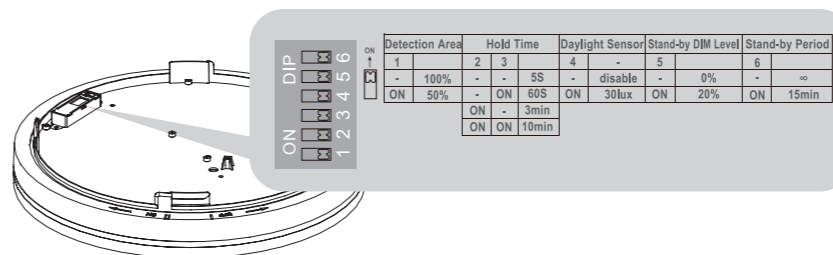

factory setting:

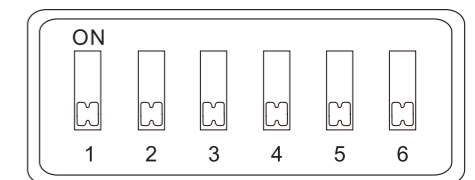

Sensor Setting:

Detection Area	
1	
-	100%
ON	50%

Hold Time	
2	3
-	5S
-	ON 60S
ON	- 3min
ON	ON 10min

Daylight Sensor	
4	-
-	disable
ON	30lux

Detection area:

Detection area can be reduced by selecting the combination on the DIP switches to fit precisely each application.

Notice 1: The test is based on a height of 3m, the radius is the ground detect distance, which can be selected through the slide switch.

Notice 2: The detective range is measured by human body whose stature is around 1.6-1.7M with medium size and traveling speed is around 1.0-1.5M per second. If the stature, bodily form and traveling speed are changed, then the detective range will be changed accordingly.

Notice 3: Test result will be highly influenced by test environment, the more open environment, the closer detect distance; the narrower environment, the longer detect distance. The detectormay do self-excitation in a narrow environment.

Hold time:

Refers to the time period the lamp remains at 100% illumination after no motion detected.

Notice 1: The hold time can be selected by the slide switch.

The hold time counting should be started after the sensor is powered on and initialized.

Daylight sensor:

The sensor can be set to only allow the lamp to illuminate below a defined ambient brightness threshold. When set to Disable mode, the daylight sensor will switch on the lamp when motion is detected regardless of ambient light level.

Notice 1: The light threshold can be selected through the slide switch, it may cause a large deviation in different lamps.

Stand-by DIM Level	
5	
-	0%
ON	20%

Stand-by dimming level:

This is the dimmed low light output level you would like to have after the hold-time in the absence of people.

Stand-by Period	
6	
-	∞
ON	15min

Stand-by period:

This is the time period you would like to keep at the low light output level before it is completely switched off in the long absence of people.

Induction Range

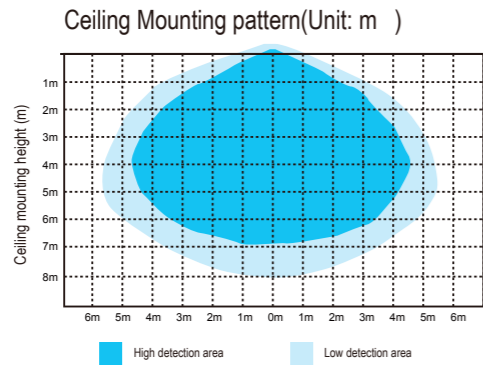

Installation Instruction

WARNING

1. Switch off before installation.
2. Switch on only after complete installation and examination of the circuit.
3. Professional electrician for installation and maintenance only.

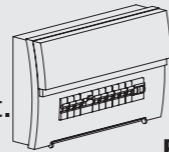

Turn Off Power Supply

How to install

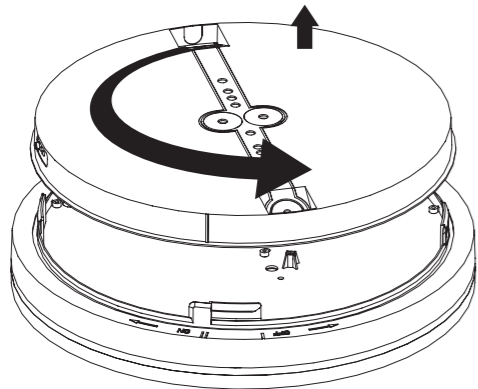
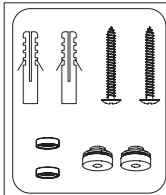

1 2-1

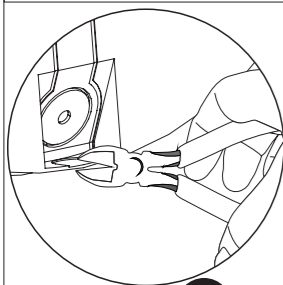
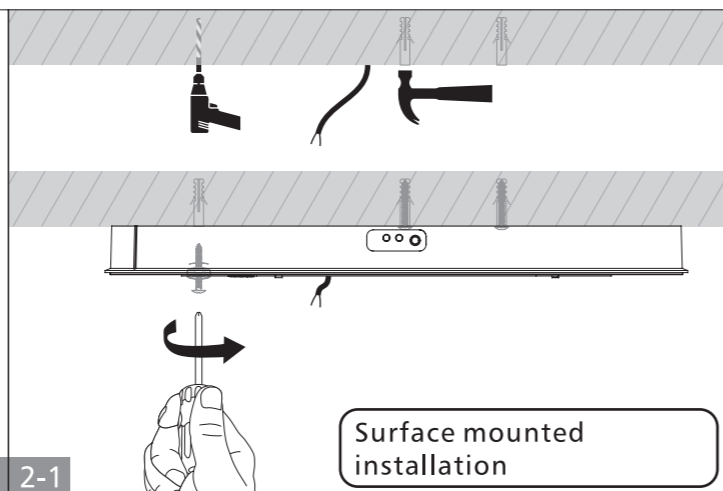

1

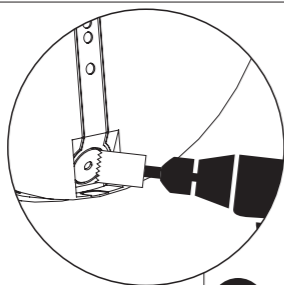

2

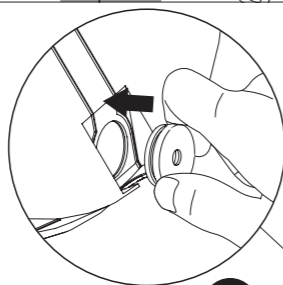

3

Φ20mm±1mm

2-2

surface mounted open wire installation

Standard sensor 3-CCT

L' = NC
L = Unswitched
N = Neutral
DA/V+ = NC
DA/V- = NC

Emergency

L' = Switched
L = Unswitched
N = Neutral
DA/V+ = NC
DA/V- = NC

DALI/0-0V

L' = NC
L = Unswitched
N = Neutral
DA/V+ = DIM+
DA/V- = DIM-

(DALI/0-10V)+Emergency

L' = Switched
L = Unswitched
N = Neutral
DA/V+ = DIM+
DA/V- = DIM-

select preferred colour temperature for product in CCT change function only

Select initial power

For adjustable sensor model, please select the sensor mode before mounting to ceiling or wall, see below picture.

Alignment

Caution, risk of Electric shock. The light source contained in this luminaire shall only be replaced by the manufacturer or his service agent or a similar qualified person.

COMPLETE

ECO
Specifications

STD
Specifications

PRO
Specifications

ODM
Specifications

INT
Intelligent

BA
L I G H T I N G

www.ba-lighting.no

post@ba-lighting.no

Tlf: 37 16 04 00

Adr: Holthesvei 2, 4848 Arendal